

GYMNASIUM

E : Electrically

Entry from Lobby

Close

15 \$50 E

14 \$40

13 \$40

12 \$40

11 \$50 E

Close

10 \$50 E

16 \$50 E

17 \$50 E

18 \$40

19 \$40

20 Prime \$40

44 \$40

43 \$40

33 \$40

42 \$40

41 \$40

35 \$40

41 \$40

40 \$40

36 \$40

39 \$40

38 \$40

37 \$40

32 \$40

31 \$40

21 Prime \$40

30 \$40

29 \$40

22 \$40

29 \$40

28 \$40

24 \$40

27 \$40

26 \$40

25 \$40

1 Prime \$50

2 \$50 E

3 \$50 E

4 \$50 E

5 \$50 E

6 \$50 E

7 \$50 E

8 \$50 E

9 \$50 E

10 \$50 E

RESERVED for Drawing Winner

Loading & Unloading 30 min / booth space

Kitchen

Vendors ONLY Lunch Window

CONFERENCE ROOM Vendors

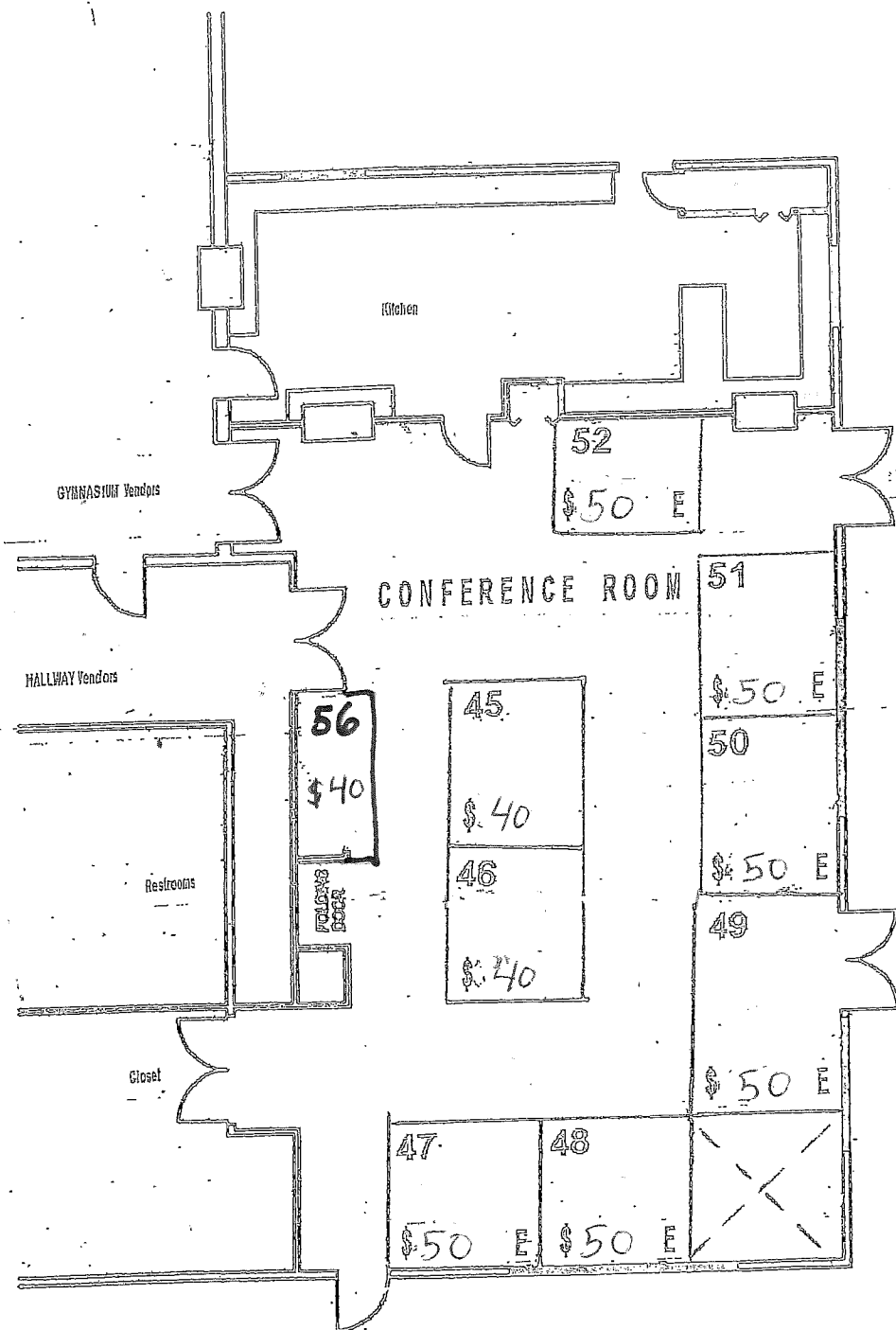

E : Electricity

Childcare

Weight Room

AEROBICS ROOM NO Vendors

GYMNASIUM Vendors

Offices

E: Electricity

HALLWAY

59
\$30
E
60
\$30
E

58
\$65

57
\$65

55
\$65
Prime

54
\$65
Prime

53
\$65
Prime

61

\$30

62

\$30

63

\$30

64

\$30

65

\$30

66

\$30

Class Windows

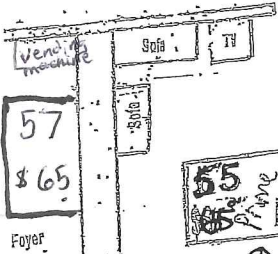

all are \$65 →

